

REVISES		REVISIONS	
BY	DATE	DESCRIPTION	APP'D
0		REL PER PR# 97-15	7-21-97 PC DS
A		REV PER EC# 0K40-0156-99	8-31-99 PC DC

- 1 ACCEPTS #4 SELF TAPPING SCREW (ELCO HI-LO THREAD CUTTING STYLE OR EQUIVALENT) TO BE DRIVEN AT 0.6±0.2 N-M.
- 2 HOUSING COLORS ARE MECHANICALLY KEYED TO MATE ONLY WITH IDENTICALLY COLORED PLUG ASSEMBLIES.
- 3 GASKET TO BE MADE FROM SILICONE (AMP P/N 0-988206-1, SARA #33341). GASKET WILL BE U.V. CURED IN PLACE.

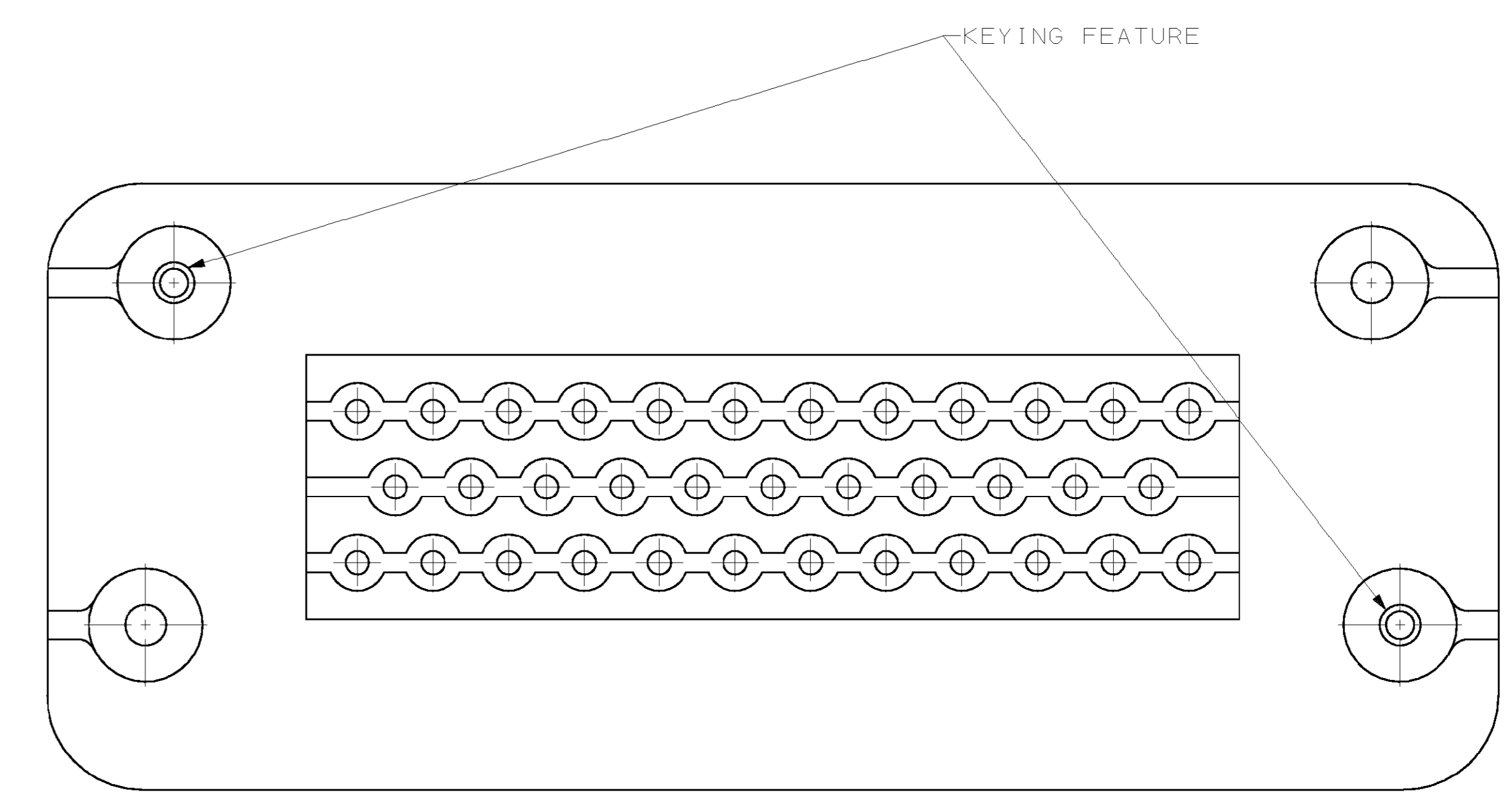

KEYING FOR 776231-1 AND 776231-4

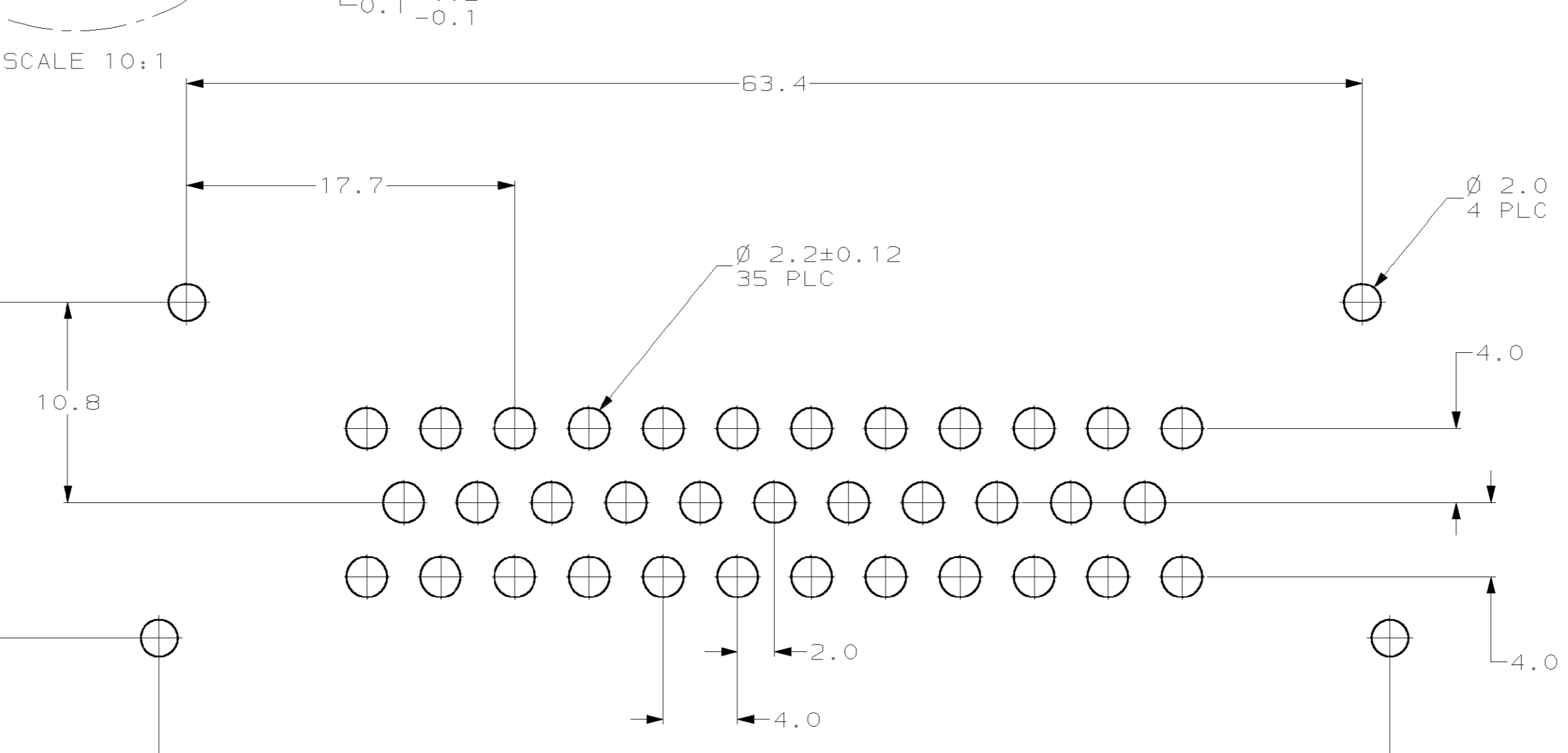
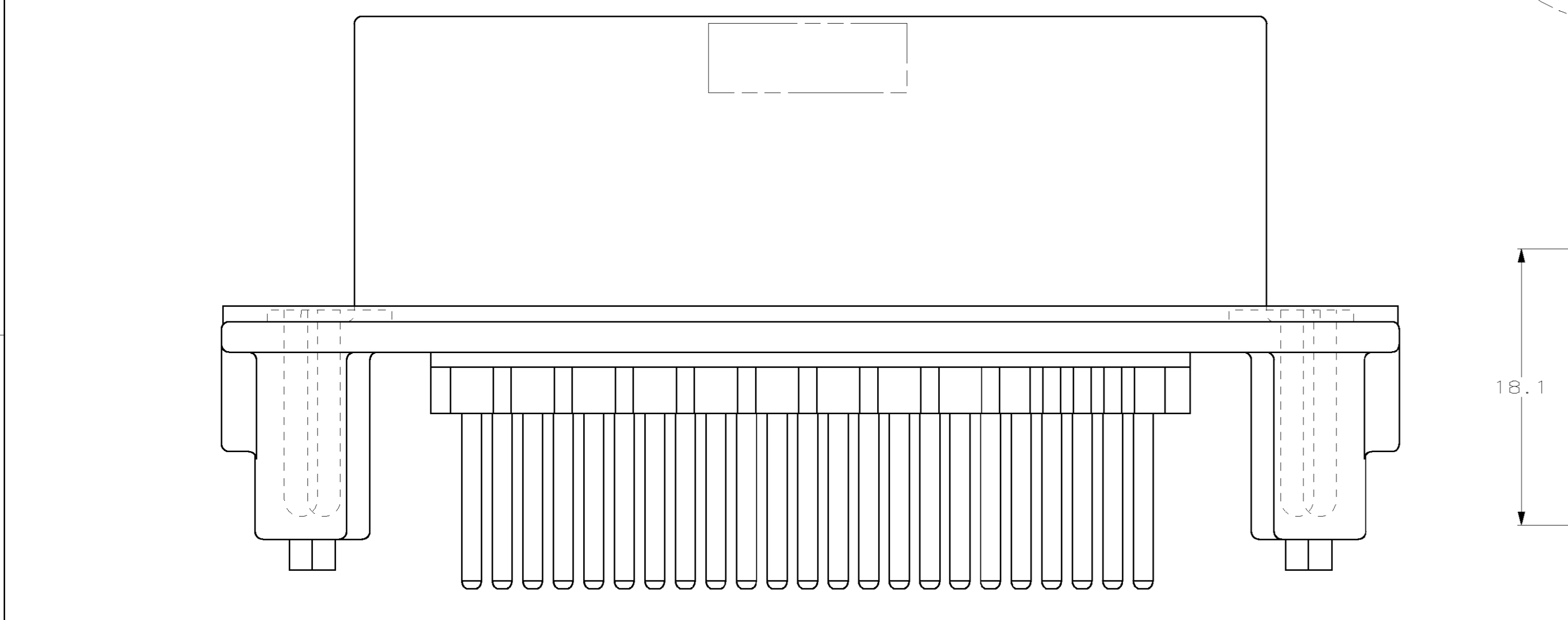
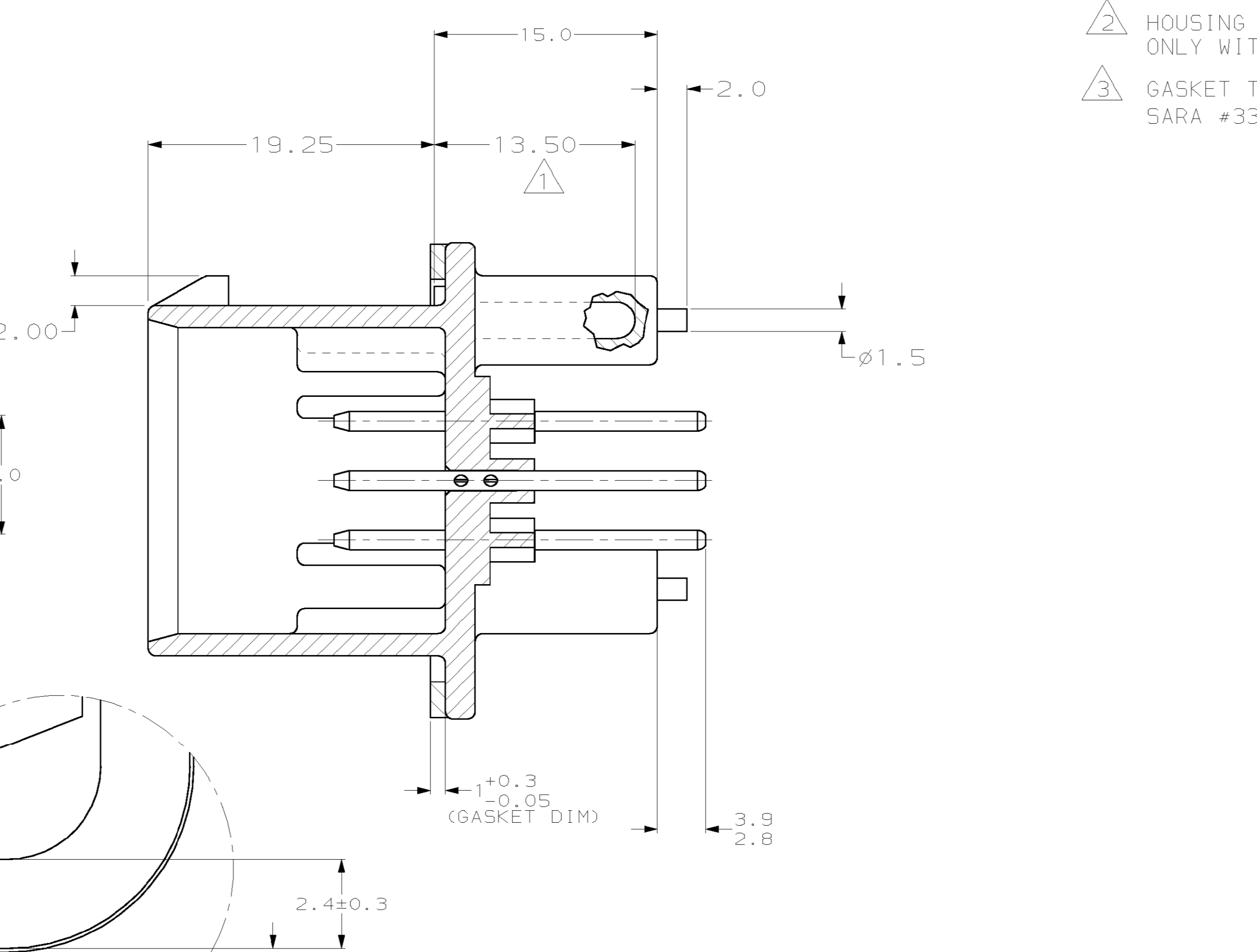
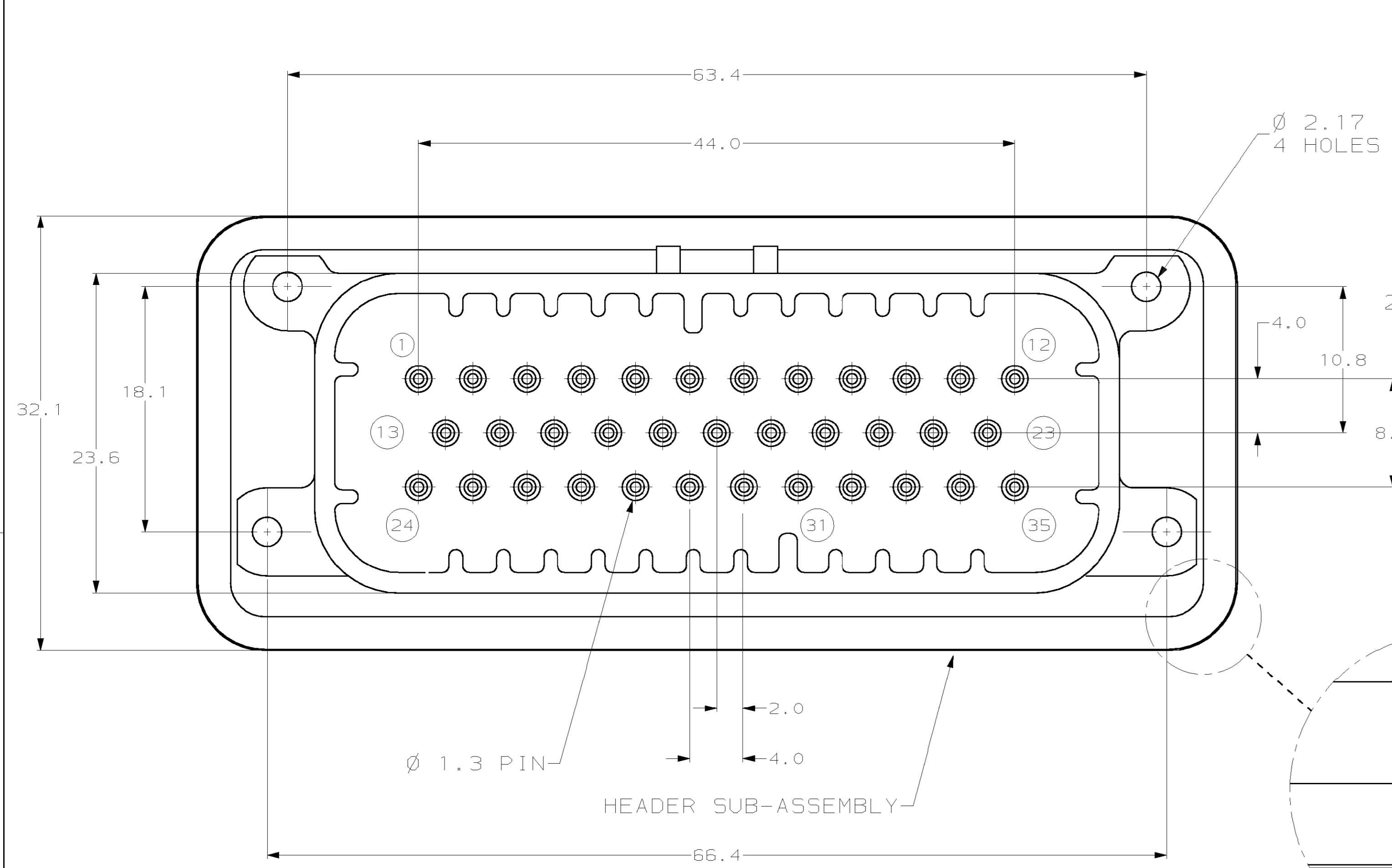
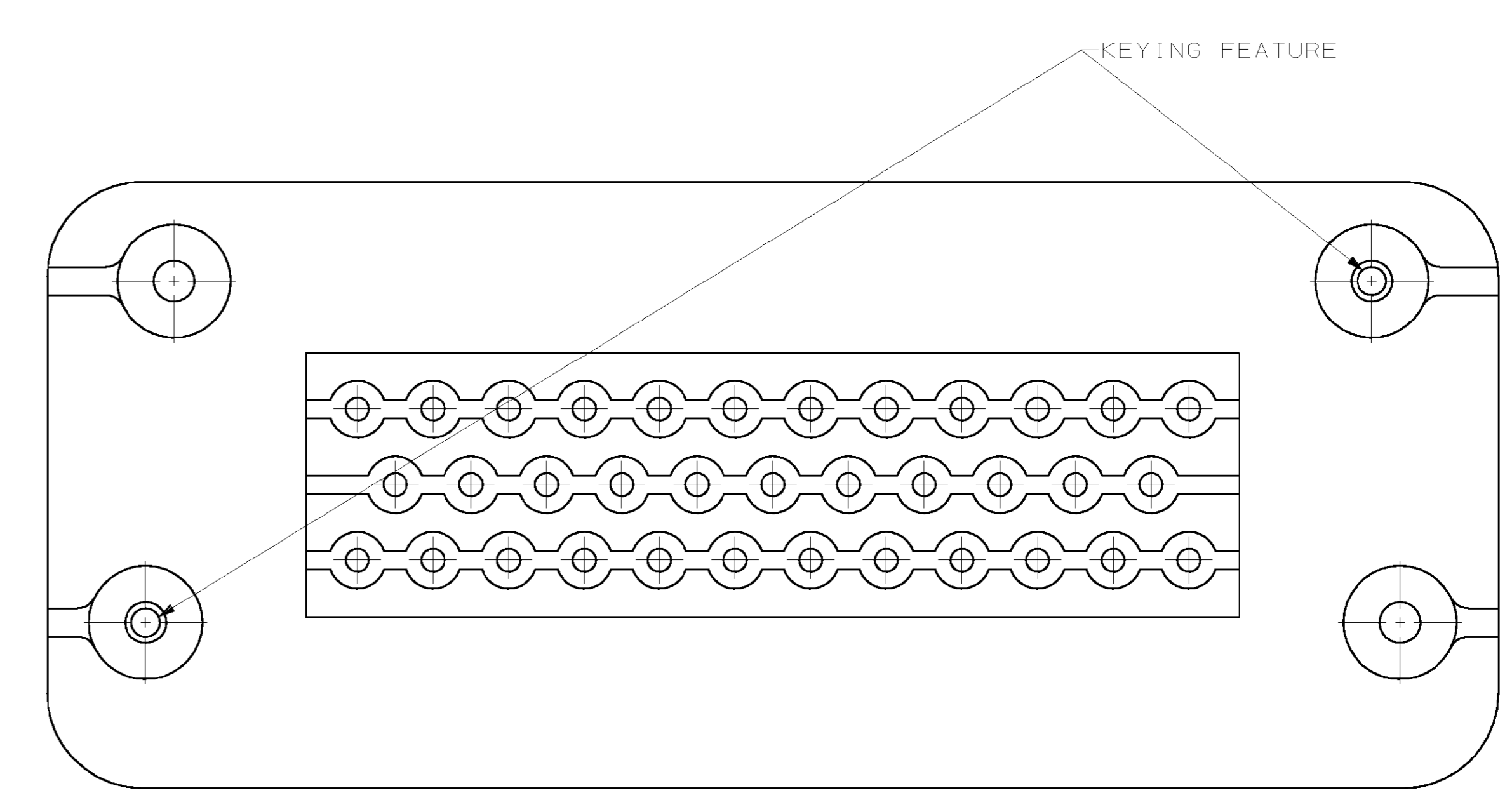

KEYING FOR 776231-2 AND 776231-5

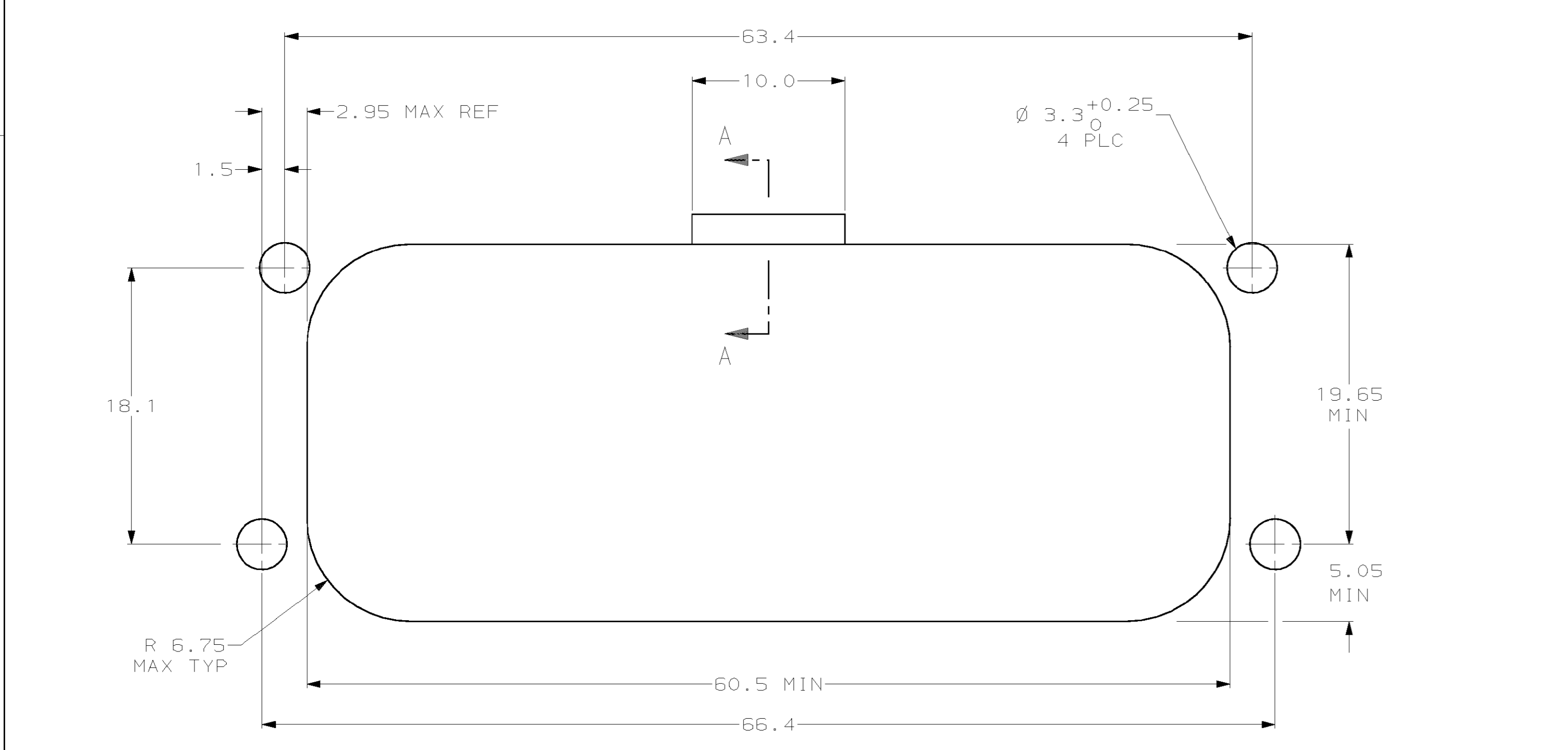

RECOMMENDED MOUNTING HOLE LAYOUT FOR 5.0 MAX THICK PANEL

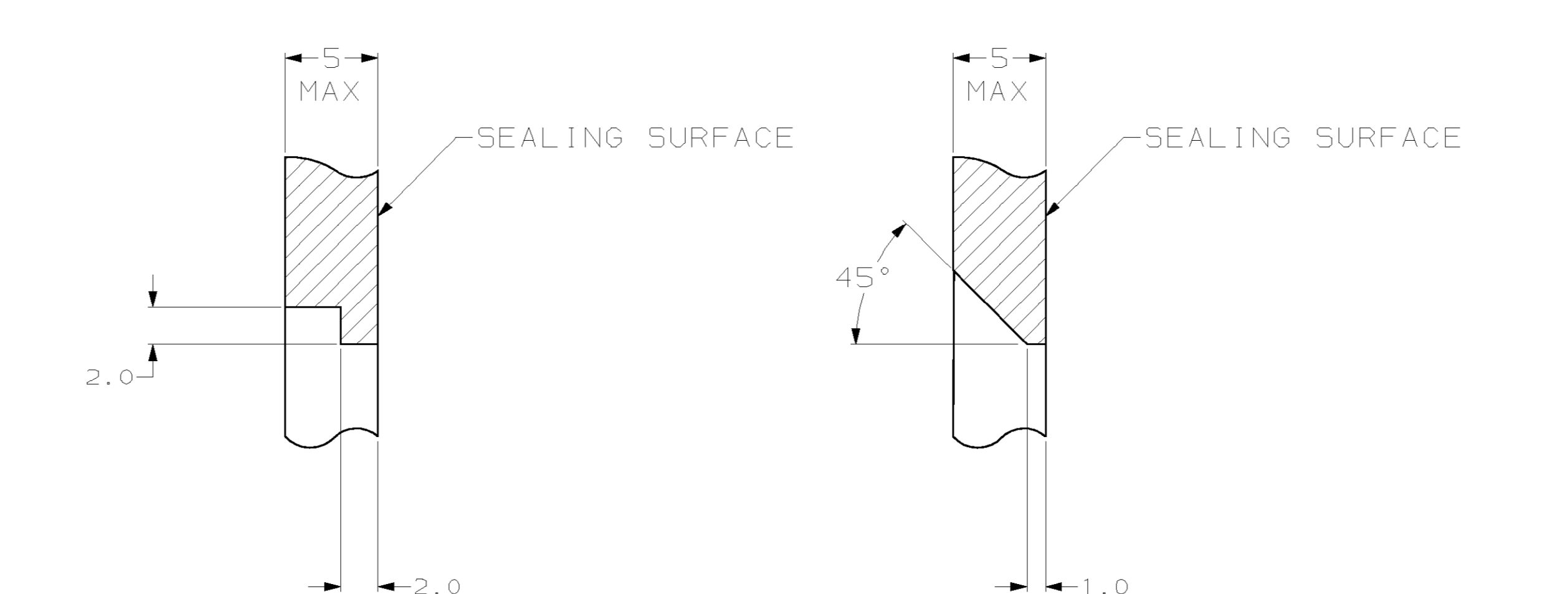

SECTION A-A OPTIONAL CONSTRUCTION IF THICKNESS IS GREATER THAN 2.0

GASKET MATERIAL	DESCRIPTION	PART NUMBER
MAKE FROM 1-776230-5		1-776231-5
MAKE FROM 1-776230-4		1-776231-4
MAKE FROM 1-776230-2		1-776231-2
MAKE FROM 1-776230-1		1-776231-1
MAKE FROM 776230-5		776231-5
MAKE FROM 776230-4		776231-4
MAKE FROM 776230-3		776231-3
MAKE FROM 776230-2		776231-2
MAKE FROM 776230-1		776231-1

SYMBOLS	TECHNICAL NOTES	OTHER SPECIFICS	DATE	BY	CHKD	APP'D
SEE TABLE	SEE TABLE		7-21-97	COLLINS	STILLIE	COLLINS
			7-21-97			
			7-21-97			

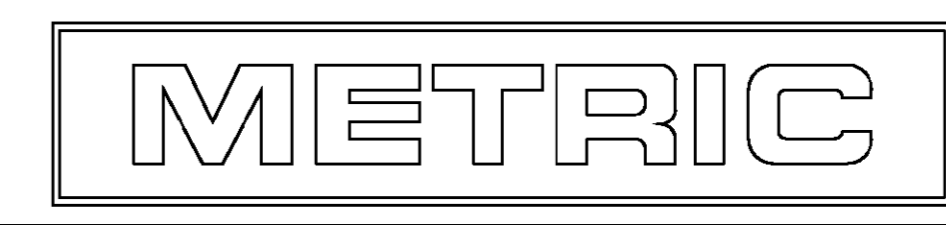

AMP AMP Incorporated
Harrisburg, PA 17105-3608

108-1323
114-16016
AO 00779 ©-776231

SCALE 4:1 SHEET 1 OF 1